

**Monteringsanvisning
Montageanleitung
Assembly instructions**

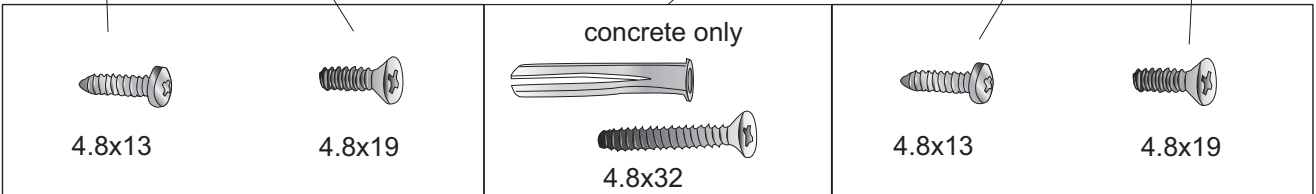

**SONO-Leerkotte
Sk rmv ggsystem VV**

SONO

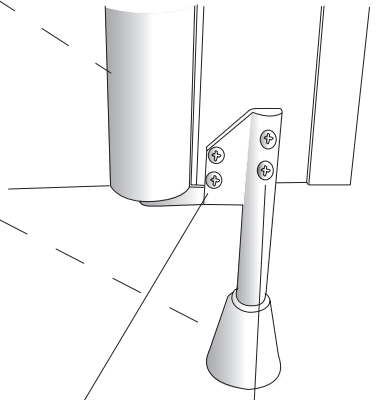
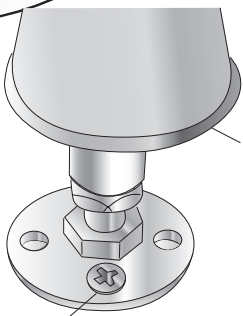
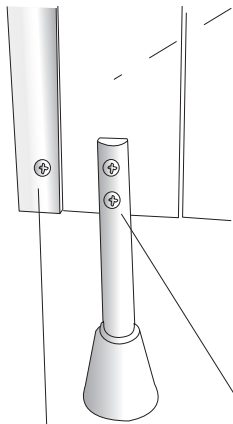
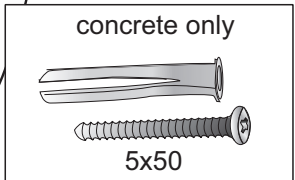
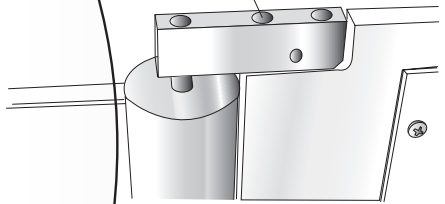
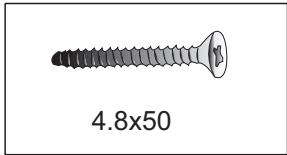
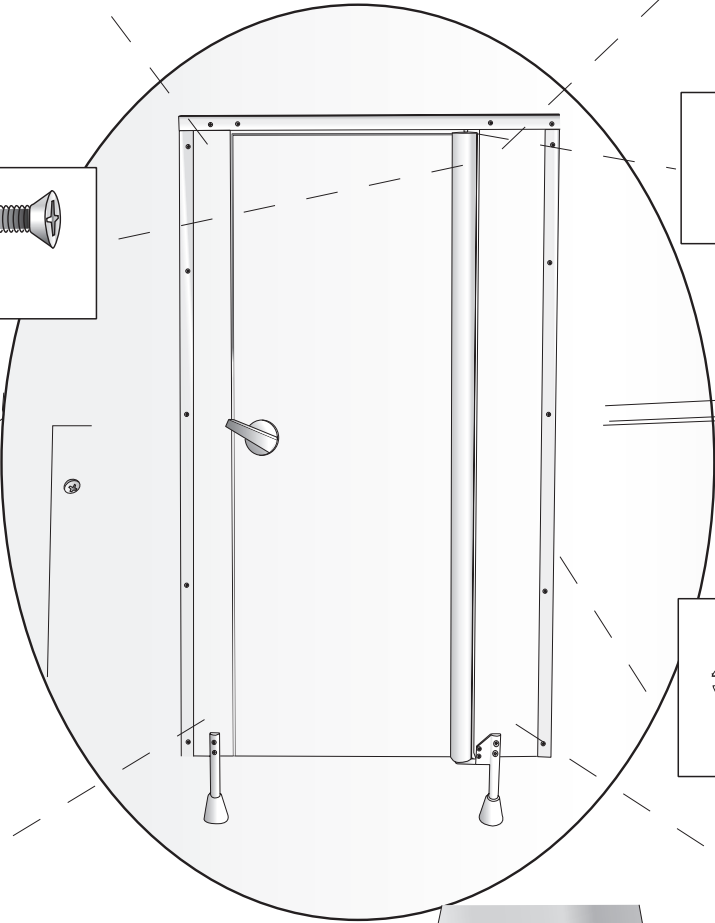
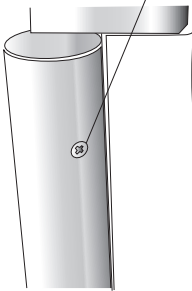
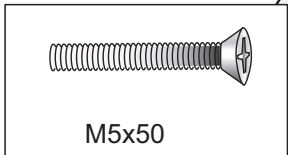
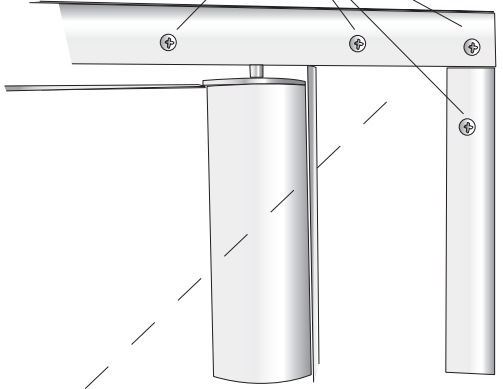
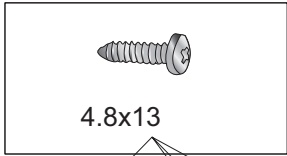
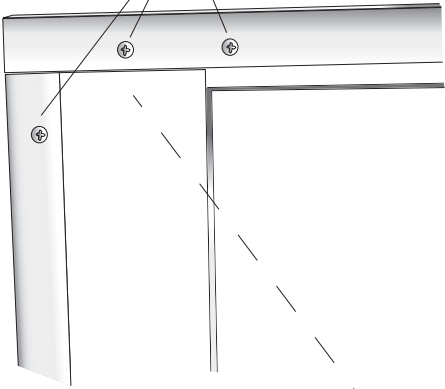
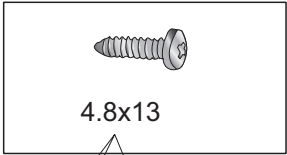

"Consolidation Profile" "Stabiliseringsprofil"

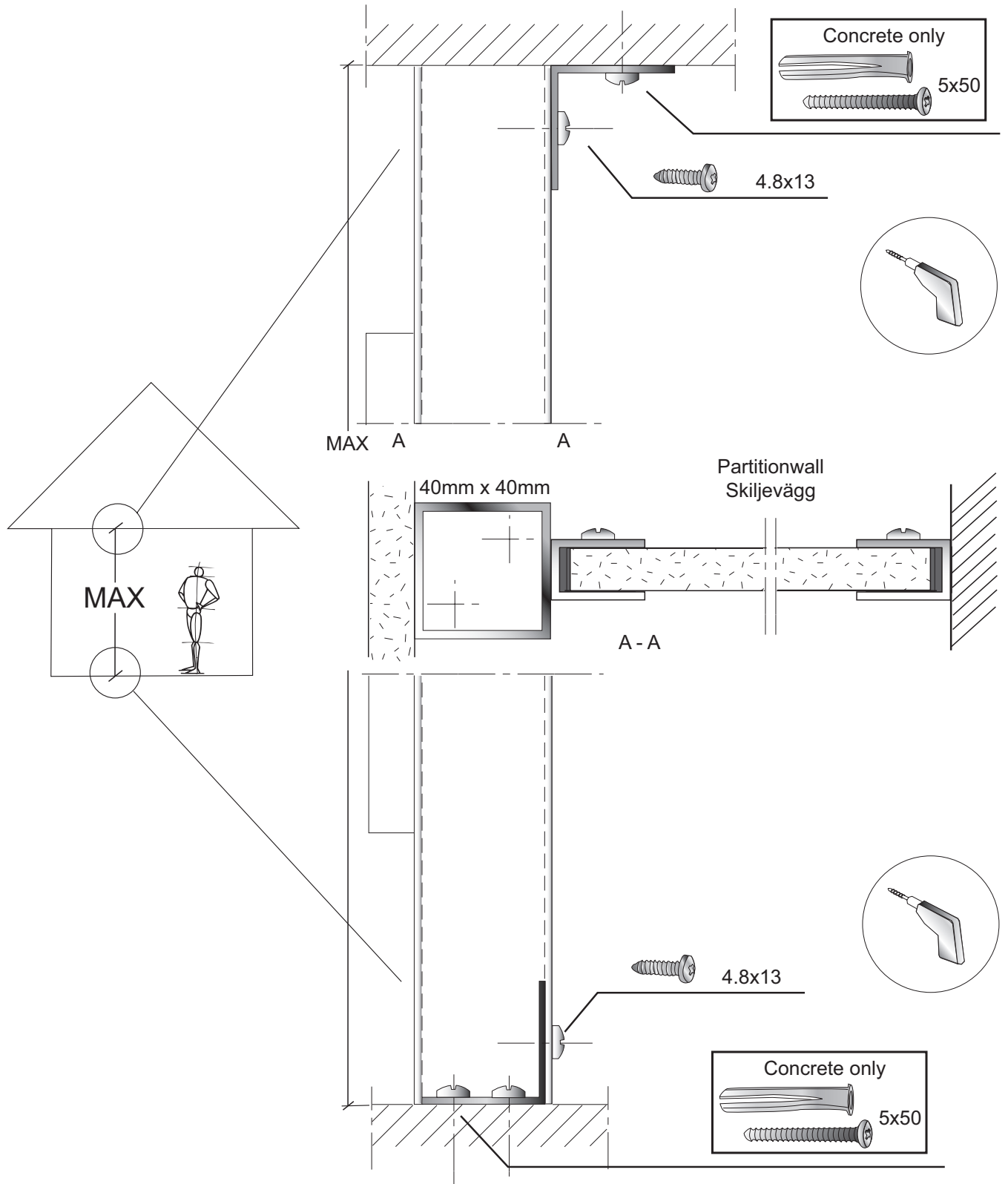

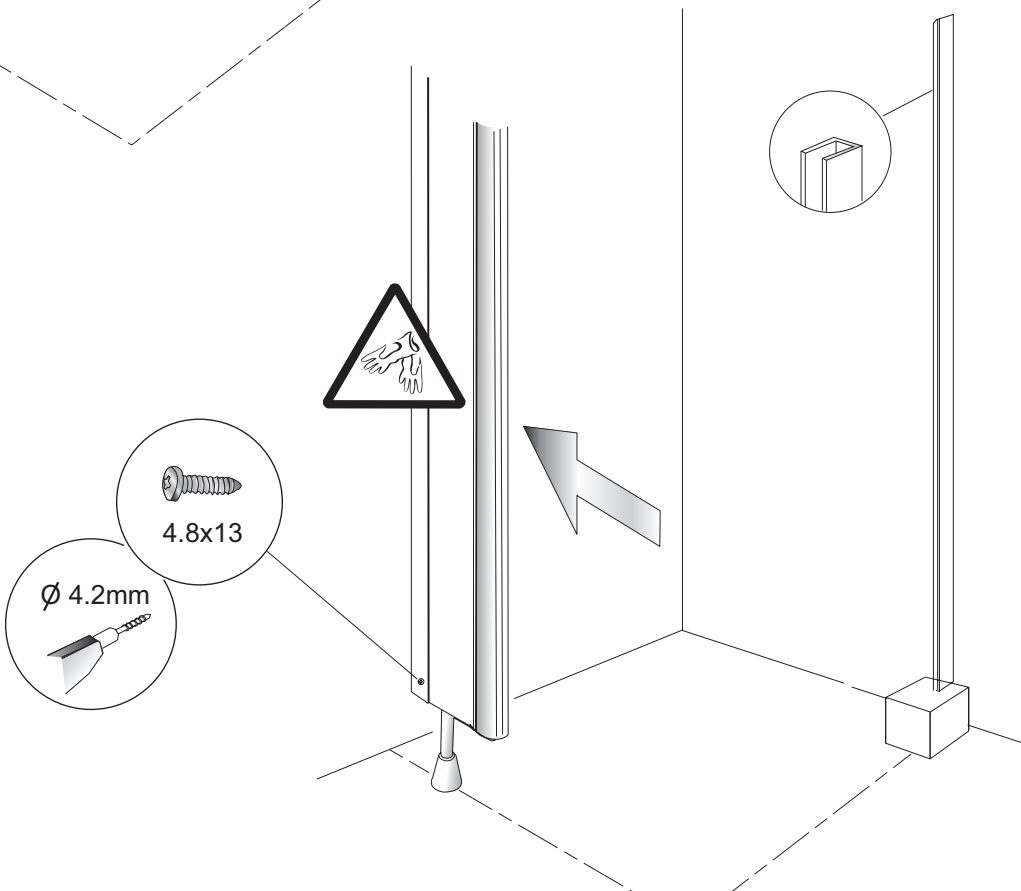
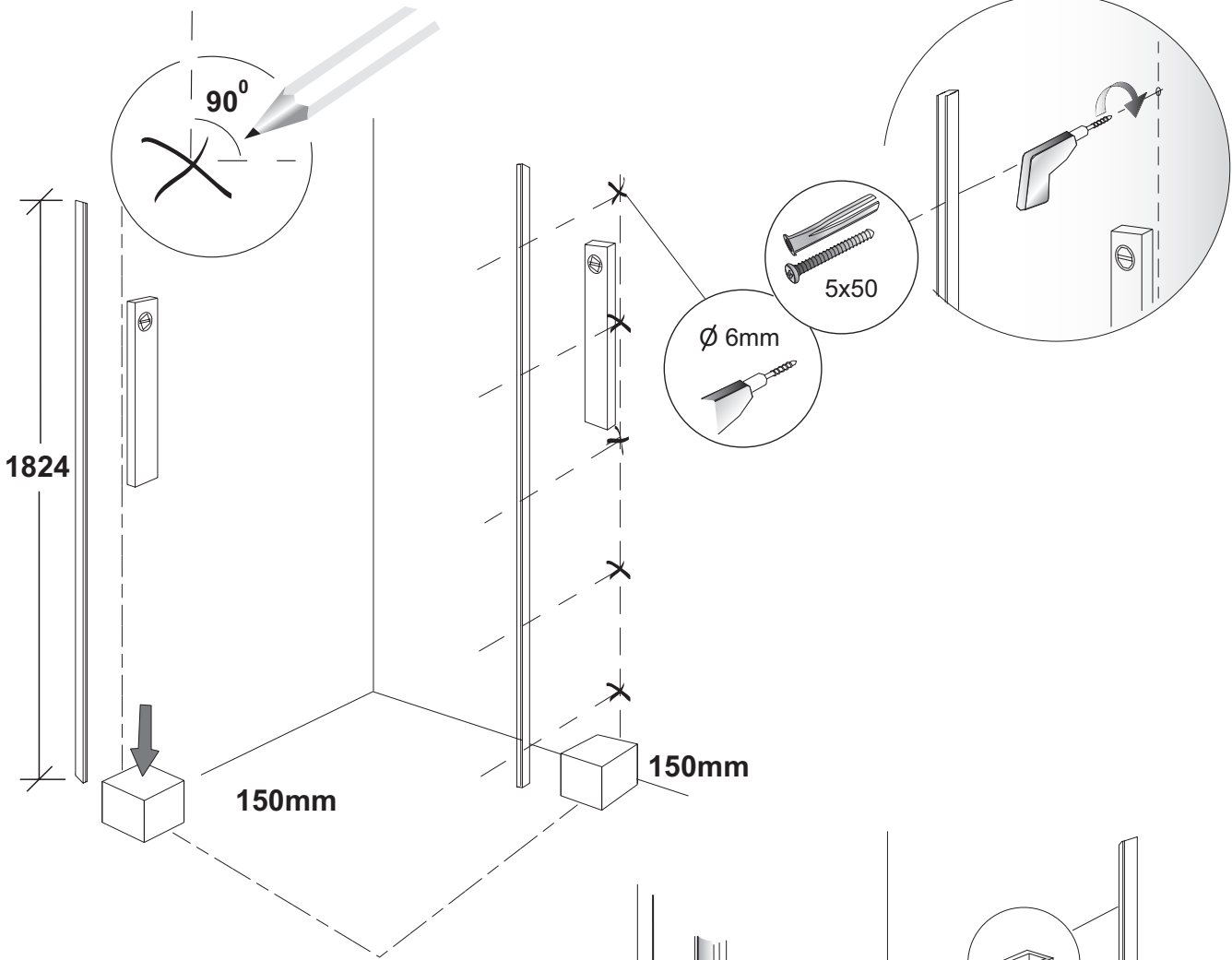

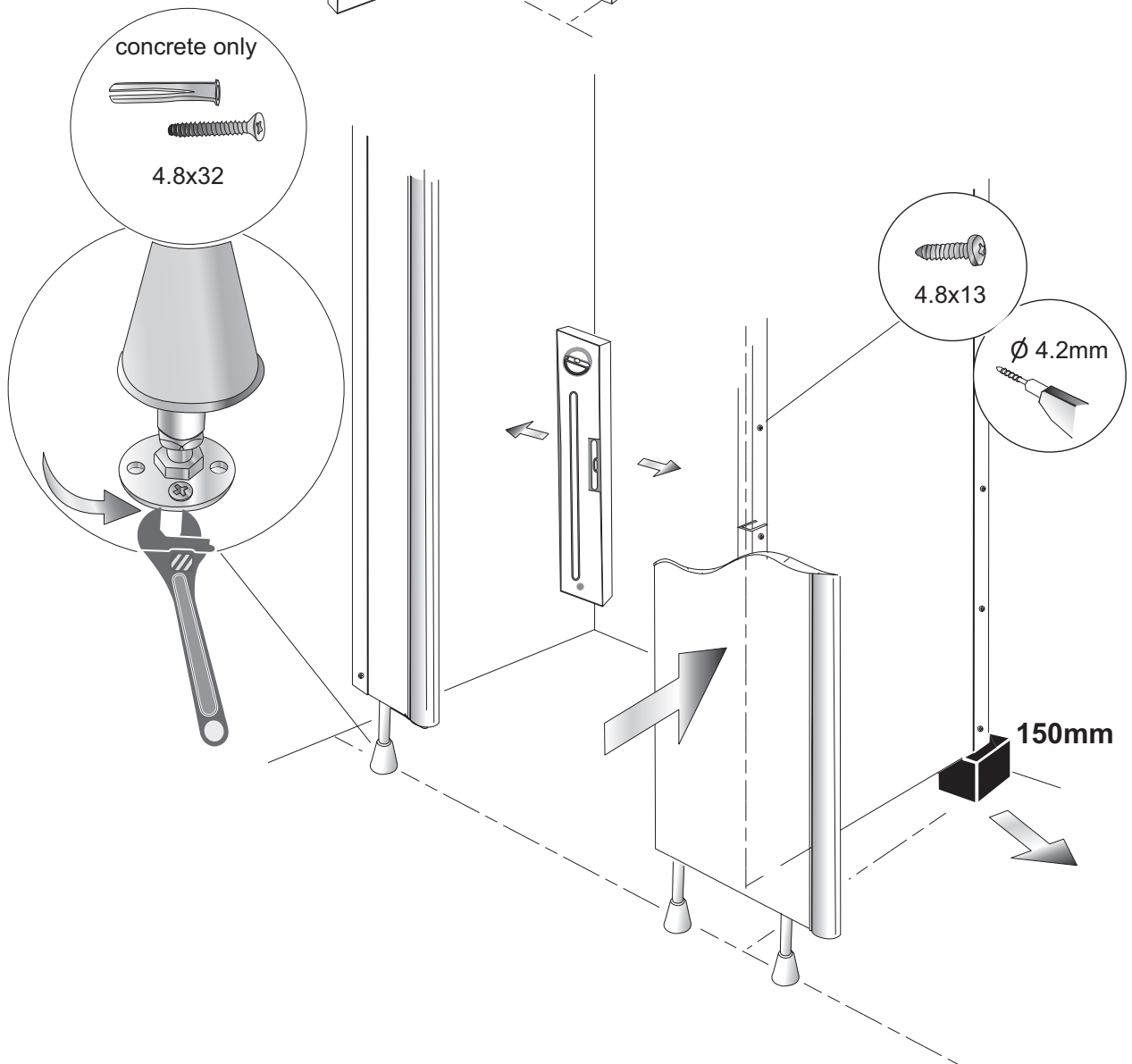
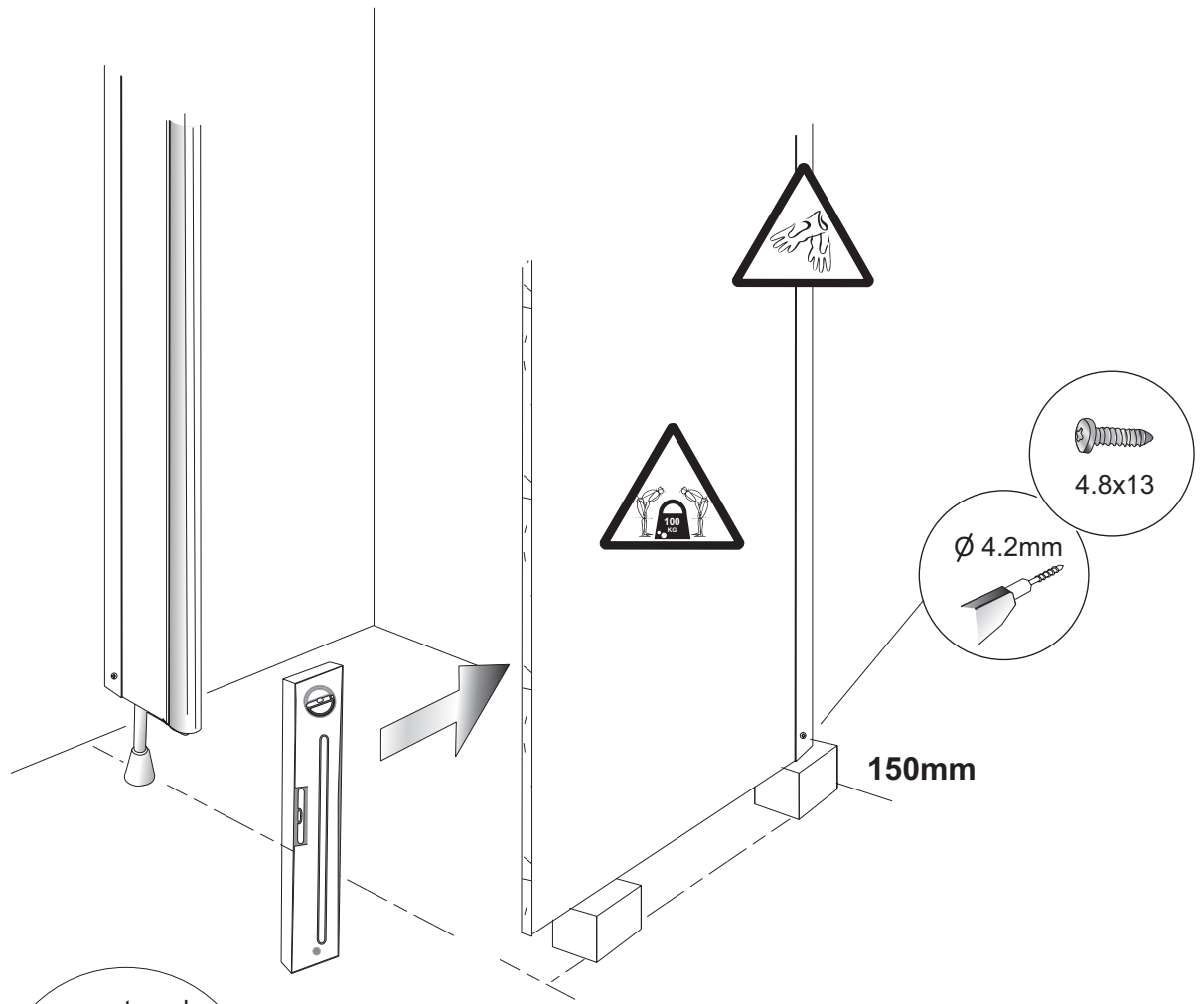

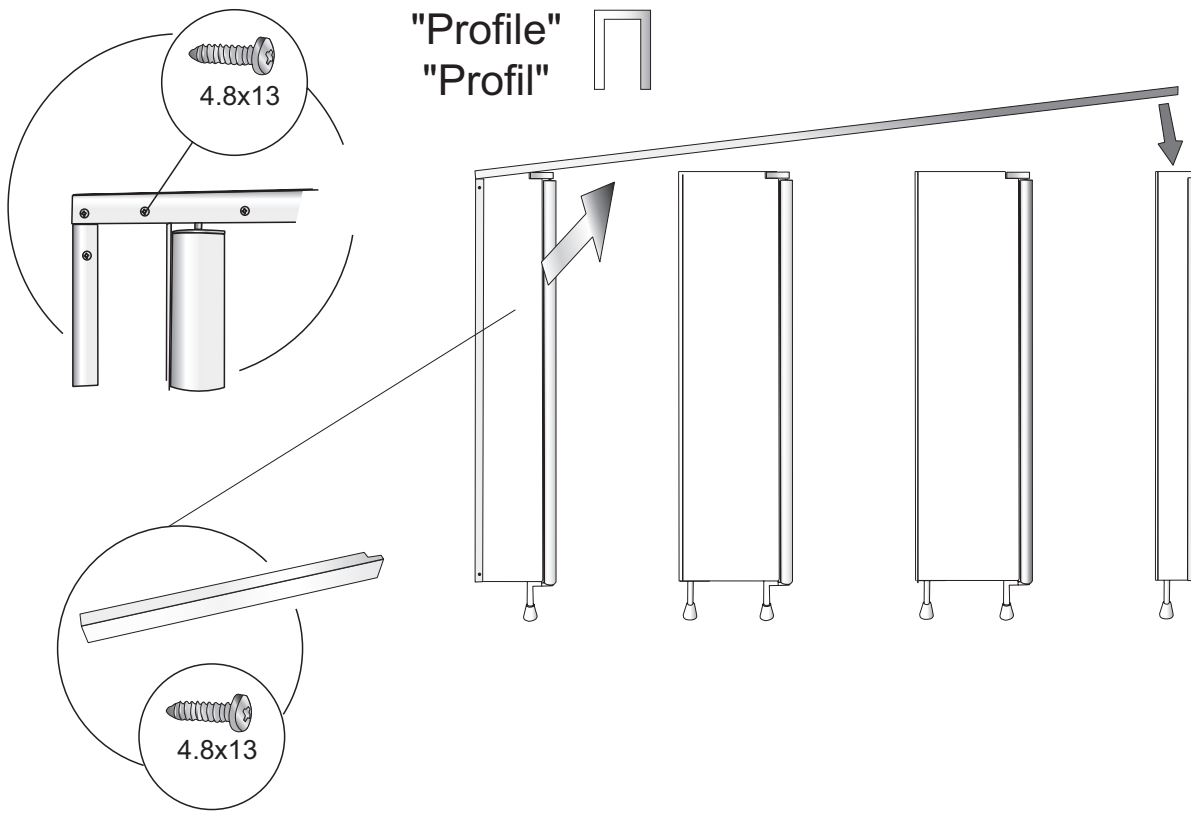

"Reinforcement Profile"
"Förstärkningsprofil"

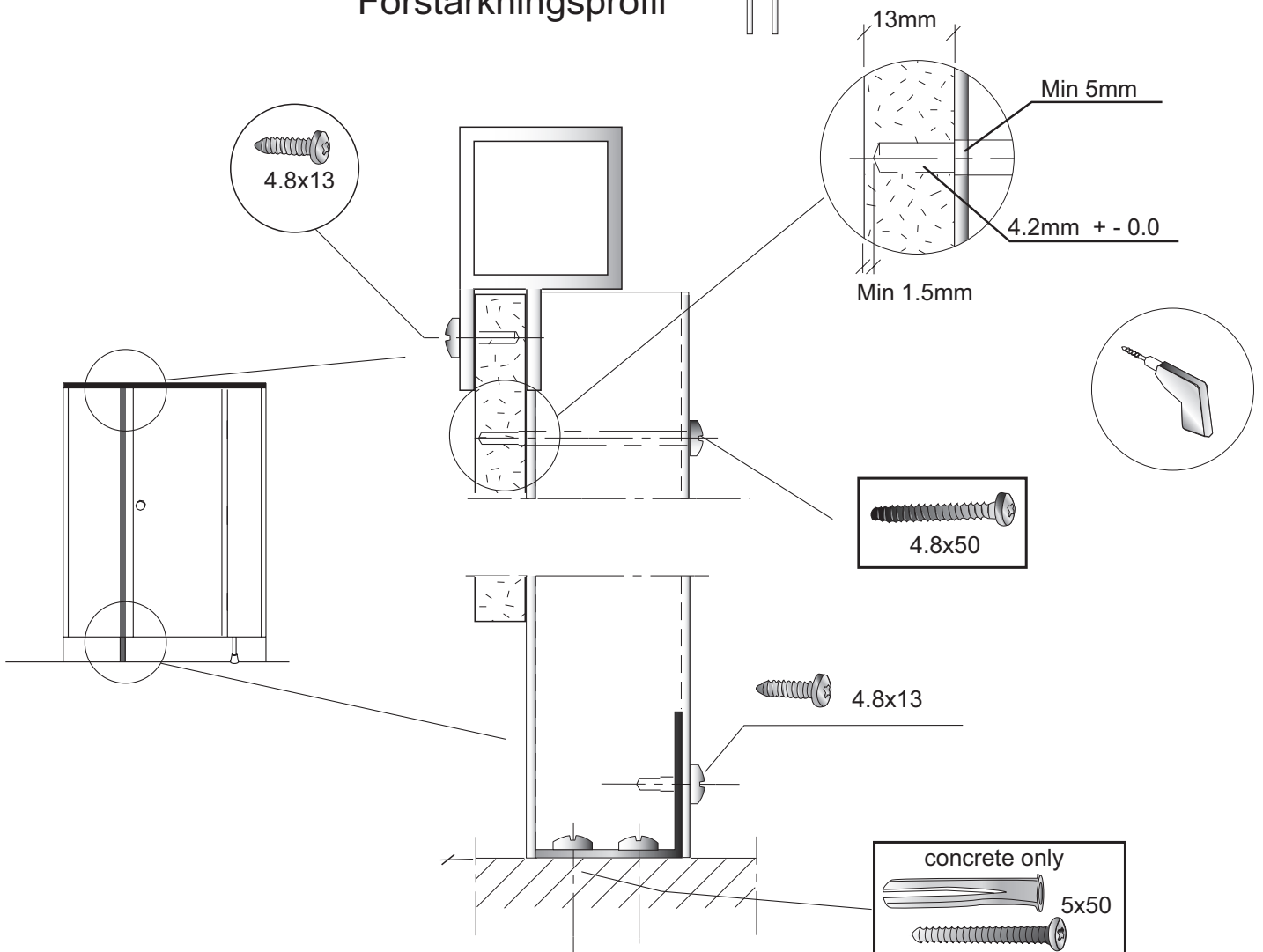

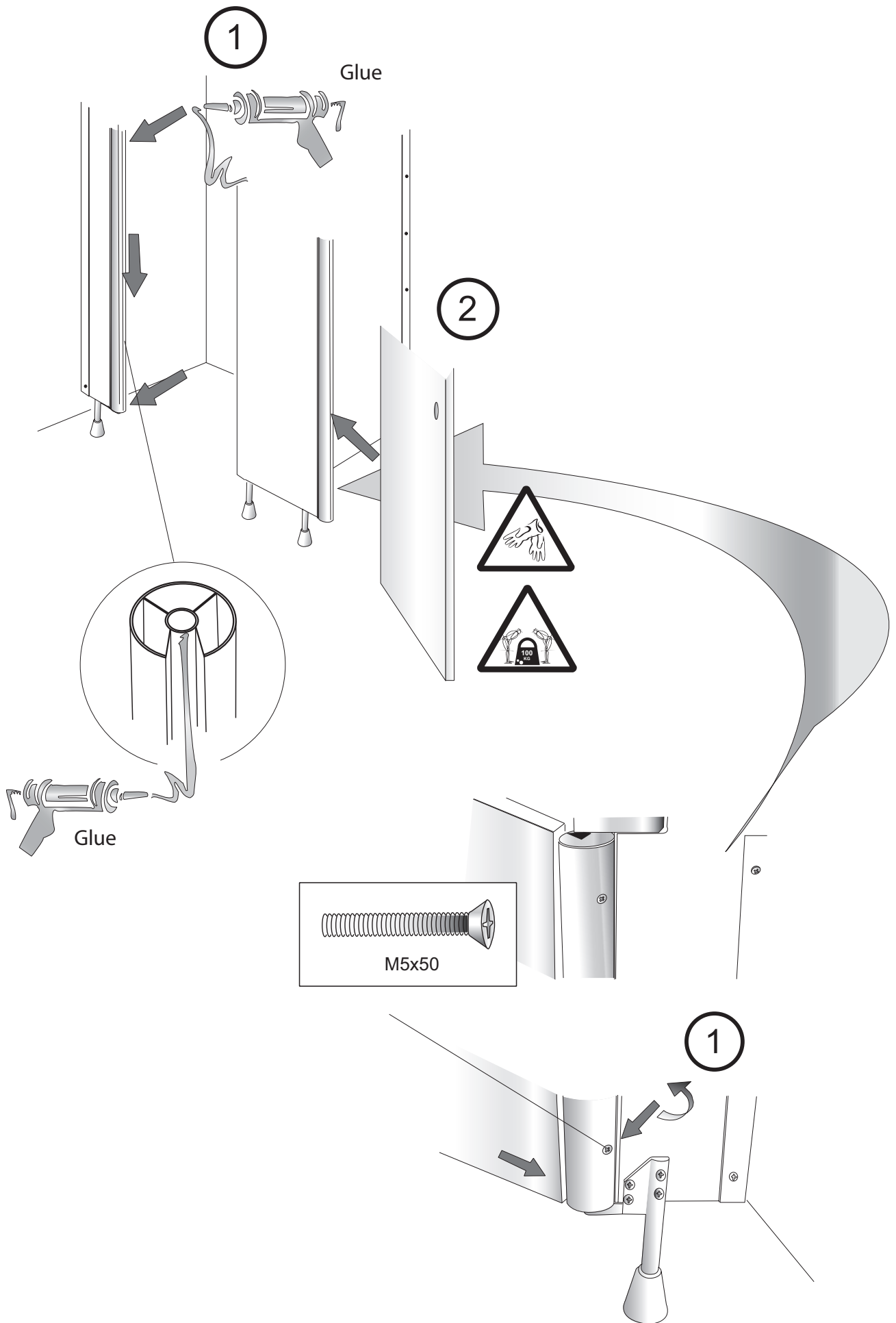

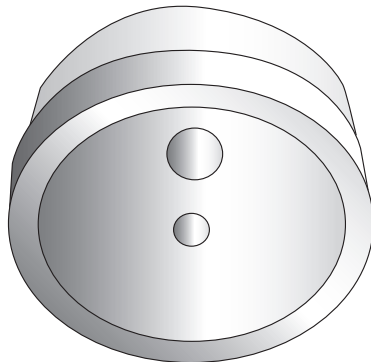
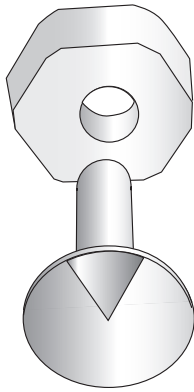
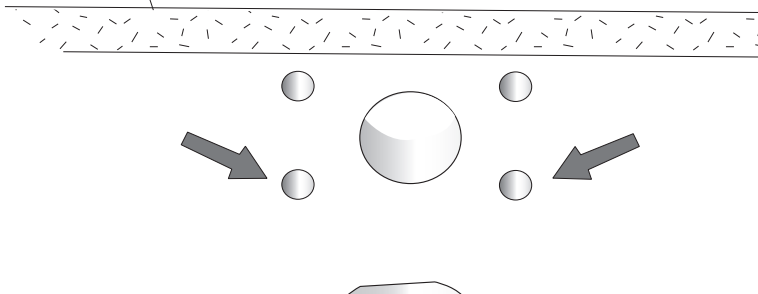
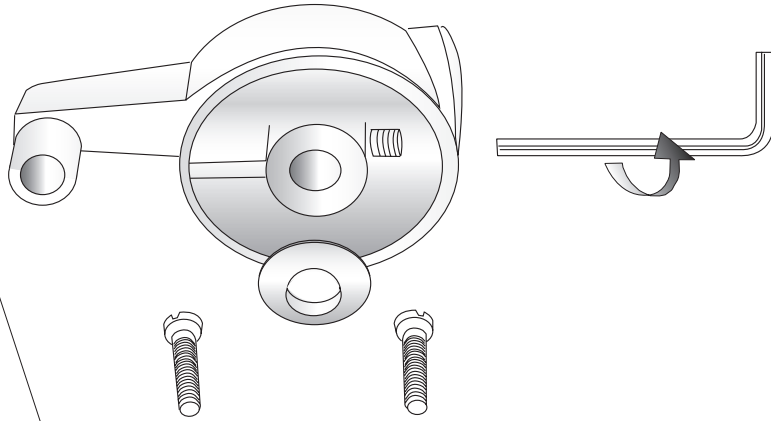
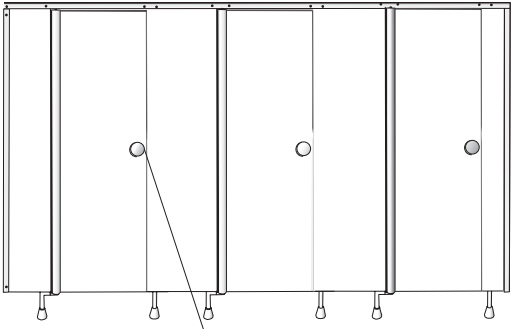



Varning för tunga lyft.
Vi rekommenderar att ni är minst två personer vid lyft av tyngre laminatprodukter.



LET OP ! Zwaar materiaal. Het wordt aangeraden zware laminaat producten met minimaal 2 personen te tillen.



Caution! Heavy weight.
Do not try to lift heavy laminate products on your own.



VORSICHT! Schwerlast. Bitte verwenden Sie geeignete Hebegeräte.



Advarsel! Det anbefales at man er minst to personer når tyngre laminatprodukter skal løftes!



Advarsel! Tungt gods. Førsøg ikke at løfte tunge produkter alene.



Varning för vassa kanter.
Vi rekommenderar att ni använder handskar.



LET OP ! Scherpe randen. Gebruik van handschoenen wordt aangeraden.



Caution! Sharp edges.
We recommend usage of gloves.



VORSICHT! Scharfe Kanten. Benutzen Sie bitte Arbeitshandschuhe.



Advarsel! Skarpe kanter! Arbeidshansker anbefales!



Advarsel! Skarpe kanter. Vi anbefaler brug af handsker.